

TUMBLE DRYERS

DX
RANGE

DX 55	DX 77	DX 90
55KG 120LB	77KG 170LB	90KG 200LB



FEATURES

- Controls:
 - Dual Digital Control or OPL Micro
- Gas, Steam heating, Electrical heating (DX55)
- Large door opening for easy loading and unloading (Ø 68cm)
- Galvanized drum
- Radial airflow
- Standard reversing drum
- Self-cleaning lint screen
- Preheating of intake air

OPTIONS

- Stainless steel drum
- Stainless steel front panel with black painted door
- Residual moisture control Sensodry+®:
 - lower energy and utility costs
 - lower linen replacement costs
- SafeTech™ Fire Suppression System



FAST DRYING



LOW ENERGY
CONSUMPTION



LARGE DOOR
OPENING

senso.dry+

SafeTech™

GET AHEAD IN LAUNDRY+

TYPE		DX55	DX77	DX90
CAPACITY				
Drum capacity 1:18	kg/lb	57/126	78/172	92/203
Drum capacity 1:22	kg/lb	46/101	64/141	75/165
Drum volume	l	1020	1410	1660
Drum diameter	mm	Ø 1120	Ø 1290	Ø 1290
AIRFLOW				
Airflow	l/s	660	1010	1010
DRYING AVERAGE				
Gas heating	g/min	979	1401	1673
Electric heating	g/min	698	-	-
MOTOR				
Fan	kW	1,1	1,1	1,1
Drive	kW	1,1	1,1	1,1
GAS HEATING				
Energy	kW	79	116	125
Energy	kBTU/h	270	395	425
Electrical connection		3x 200-240V/50-60Hz, 3x 440-480V/50-60Hz, 3x 380-415V/50-60Hz		
Gas connection	NPT	1"	1"	1"
STEAM HEATING				
High pressure 6,9 bar	kW	54,95	77,81	77,81
	kBTU/h	187,5	265,5	265,5
Electrical connection		3x200-240V/50-60Hz, 3x440-480V/50-60Hz, 3x380-415V/50-60Hz		
Steam connection	NPT	¾"	¾"	¾"
ELECTRICAL HEATING				
Energy	kW	60	-	-
Electrical connection		3x230-240V/50-60Hz 3x380V/50-60Hz 3x400-415V/50-60Hz 3x440V/50-60Hz 3x460-480V/50-60Hz		
EXHAUST				
	Ø /mm	254	305	305
DIMENSIONS				
Size H×W×D	mm	2175×1170×1725	2390×1345×1775	2390×1345×1965
Net weight (E, G, S)	kg	565, 555, 605	- , 635, 705	- , 705, 770
TRANSPORT DATA				
Packed (foil) H×W×D	mm	2290×1220×1820	2510×1320×1870	2510×1320×2070
Gross weight (foil,E,G,S)	kg	600, 585, 635	- , 670, 740	- , 740, 805
Packed (crate) H×W×D	mm	2310×1350×1890	2550×1530×1950	2550×1530×2140
Gross weight (crate,E,G,S)	kg	675, 660, 710	- , 755, 825	- , 825, 895

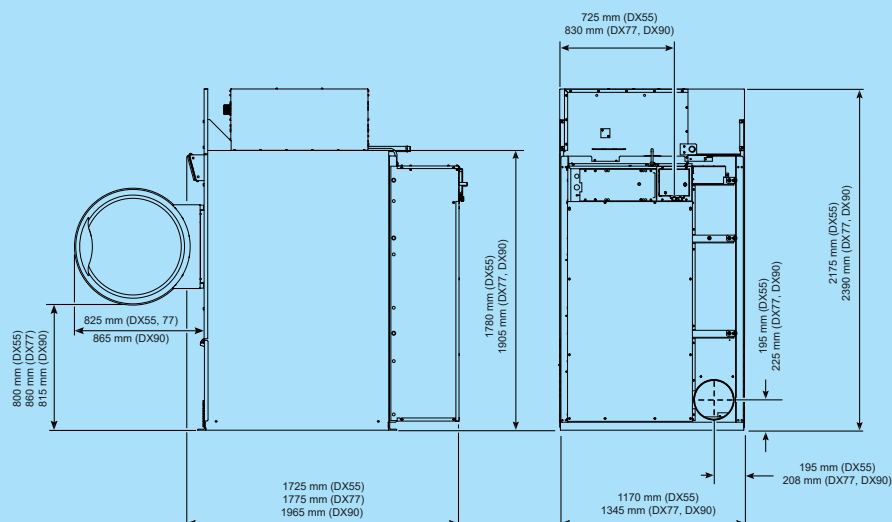

The Primus preserves the right to change the machines and the specification in this leaflet at any time, without prior notice. Details and photographs are only for information and never binding.

www.primuslaundry.com



Primus by Alliance Laundry Systems